



***Y PWYLLGOR
CYNLLUNIO***

21 MEDI 2017

***RHANBARTH Y
DWYRAIN***

**PLANNING
COMMITTEE**

21 SEPTEMBER 2017

**AREA
EAST**



CEISIADAU YR ARGYMHELLIR EU BOD YN CAEL EU GWRTHODWYD

**APPLICATIONS RECOMMENDED FOR
REFUSAL**



E/35527



A Better Place...Environment

E/35478

LOCATION PLAN

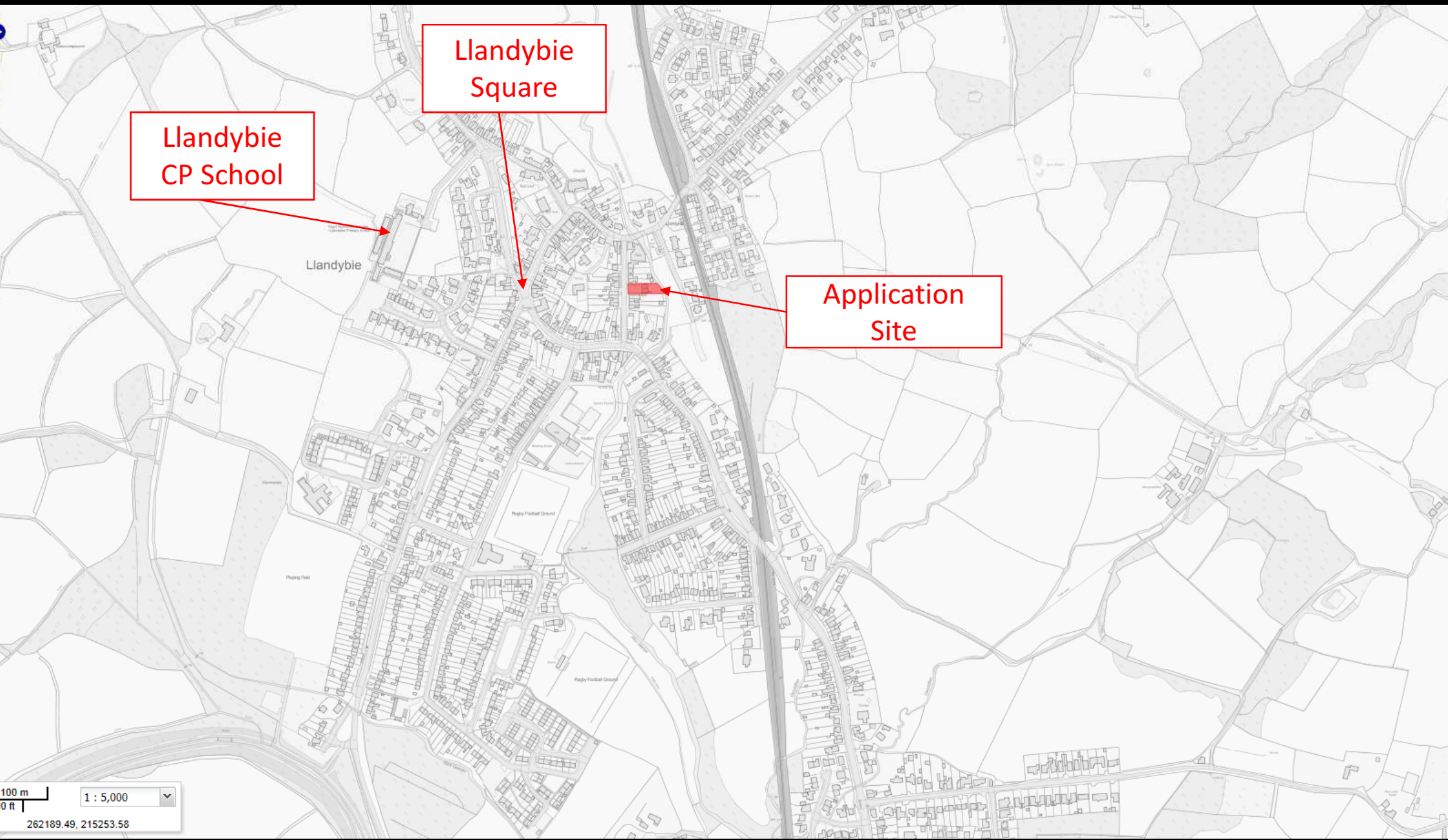

Llandybie
CP School

Llandybie
Square

Application
Site

E/35478

SITE PLAN

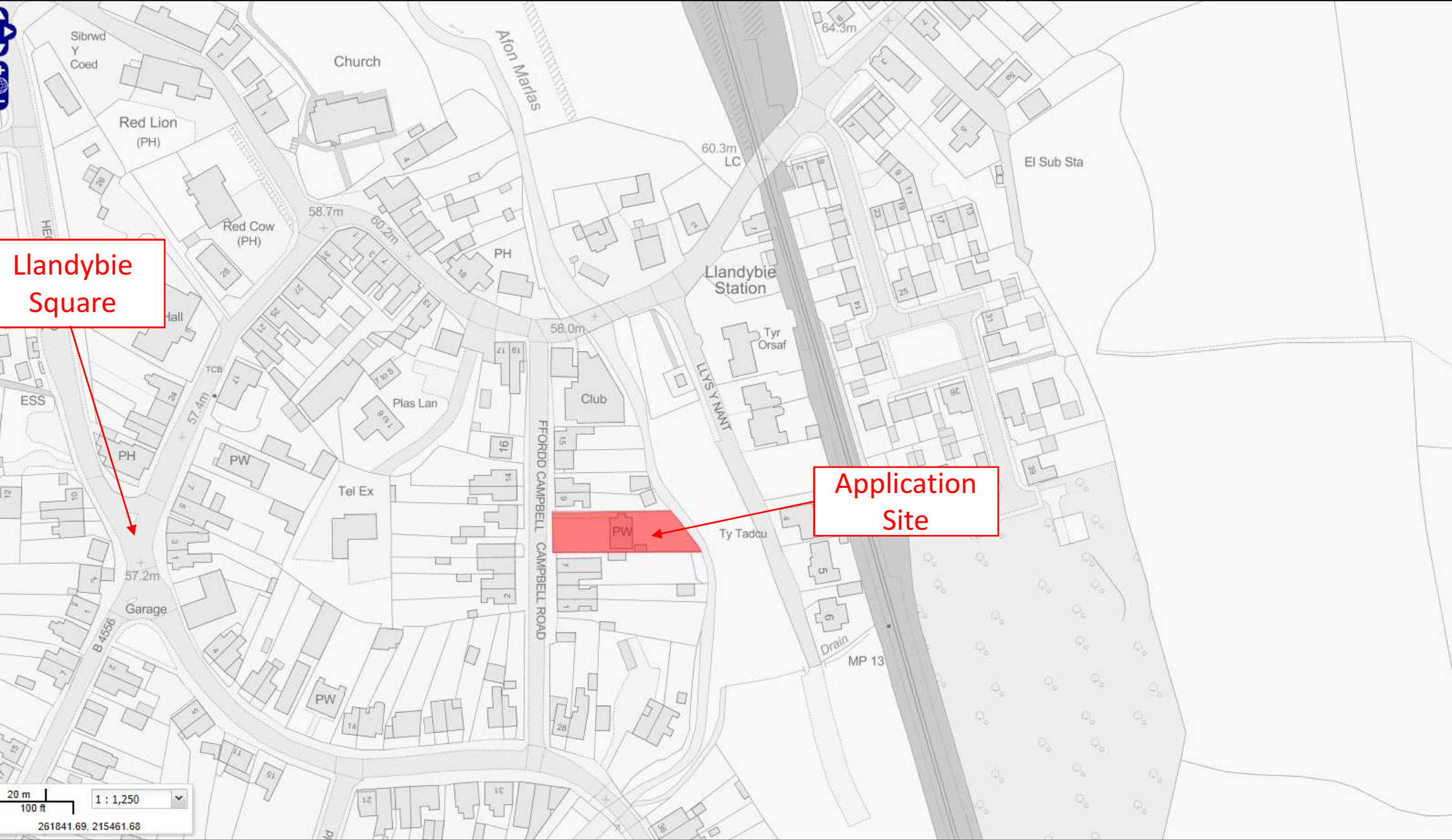

E/35478

C2 FLOOD ZONE PLAN



E/35527 AERIAL PHOTO OF APPLICATION SITE



E/35478 SITE PLAN

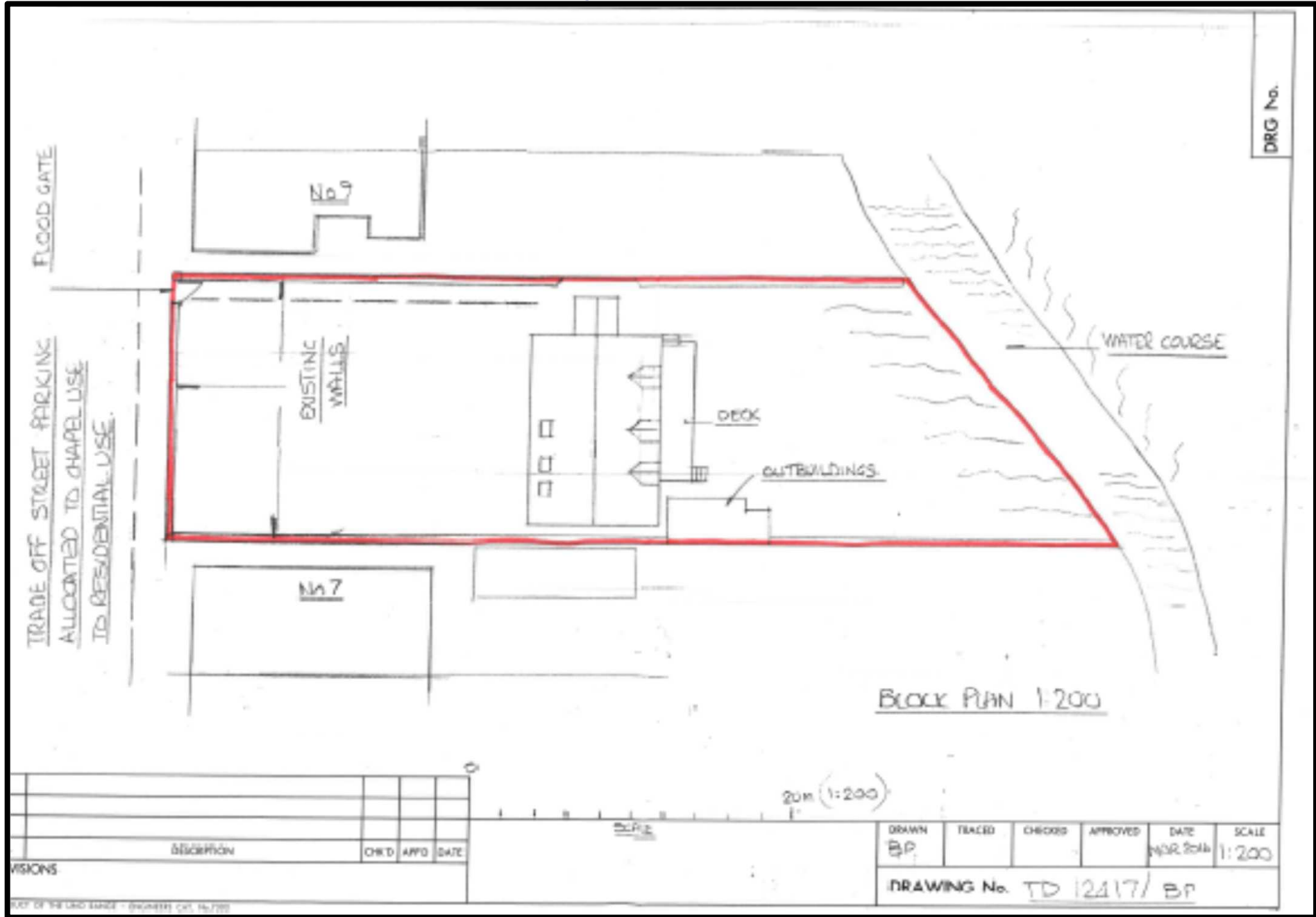

DRG No.

Block PLAN 1:200

| DESCRIPTION | CH'D | APP'D | DATE |
|-------------|------|-------|------|
| | | | |
| | | | |
| | | | |

| DRAWN | TRACED | CHECKS | APPROVED | DATE | SCALE |
|-------|--------|--------|----------|----------|-------|
| BP | | | | NOR 2014 | 1:200 |

DRAWING No. TD 12417/ BP

E/35478 EXISTING AND PROPOSED PLANS

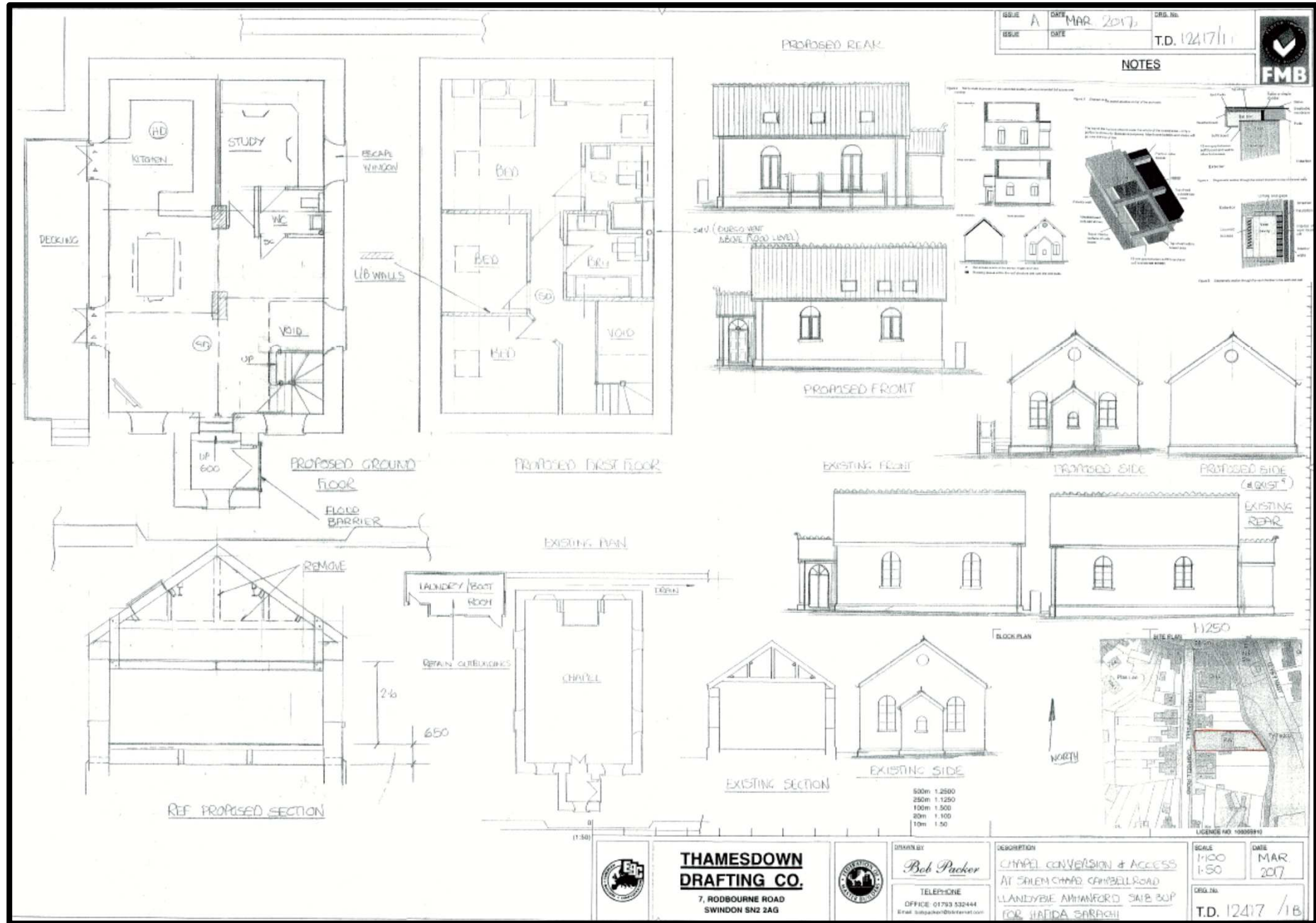

| | | | | |
|--|---|--|----------------------|-----------------------------|
| THAMESDOWN DRAFTING CO. 7, RODBOURNE ROAD SWINDON SN2 2AG | DRAWN BY Bob Packer TELEPHONE OFFICE 01753 532444 Email: b.packer@thamesdown.co.uk | DESCRIPTION CHAPEL CONVERSION & ACCESS AT SALEM CHAPEL CAMPBELL ROAD LLANDYBIE AMHERFORD SAIS BOP FOR HAFIDA SARACHI | SCALE 1:100 | DATE MAR 2017 |
| | | | LEGEND NO. 100099910 | DES. NO. T.D. 12417 / 1B |

E/35527

SITE PHOTO



E/35527

SITE PHOTO



E/35527

SITE PHOTO



E/35527

SITE PHOTO



E/35527

SITE PHOTO

